

Instruction Sheet

Kit Number: 72602700

FRONT CASTER MOUNT KIT



WARNING: FAILURE TO FOLLOW INSTRUCTIONS could result in personal injury and/or damage to unit.

Read, understand, and follow all safety practices in Operator's Manual before beginning.

Package Contents

Check the contents of your kit for the parts listed below
Also see Figure 1.

Item	Description	Qty	AriensCo P/N
1	Right Caster Arm	1	04594151
2	Left Caster Arm	1	04594051
3	3/4" x 3/4" x 1" Flange Bushing (Preinstalled)	4	03985500
4	3/8"-16 x 5 1/2" Hex Bolt	4	05982000
5	3/8"-16 Locking Top Flange Nut	4	06500822

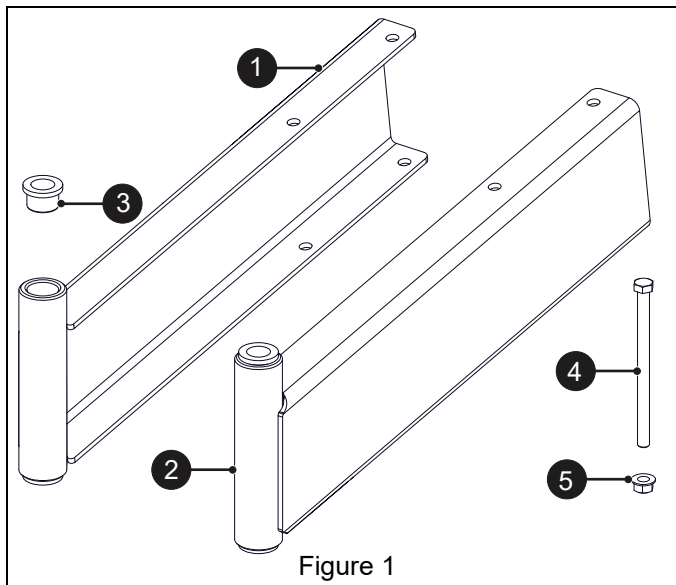

Figure 1

INSTALLATION

1. Stop unit and remove key.
2. Wait for all moving parts to stop and for hot parts to cool.
3. Press down on the handlebar to raise the brush head up and place a sturdy jackstand under the tractor frame. Chock the wheels to help prevent unit from rolling backward. See Figure 2.

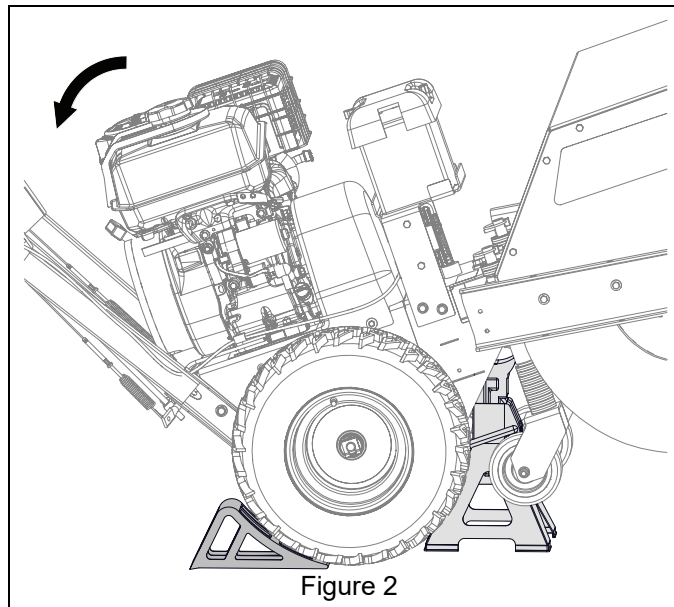
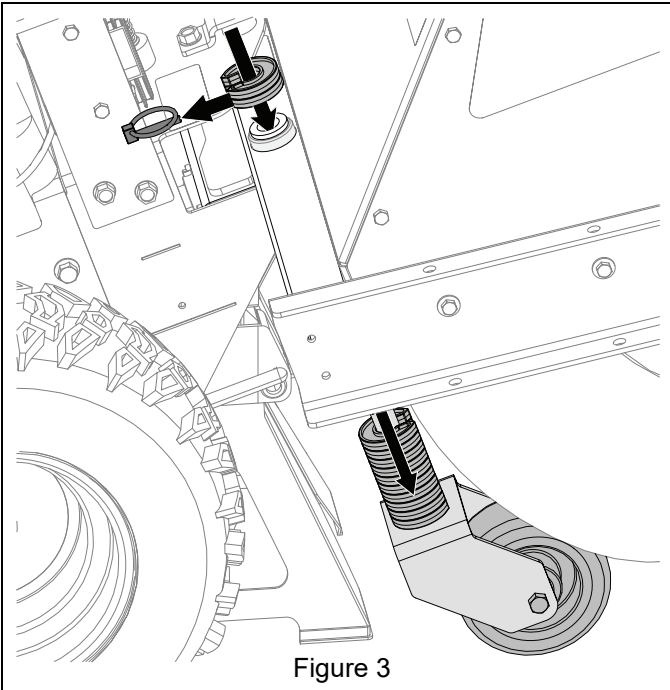
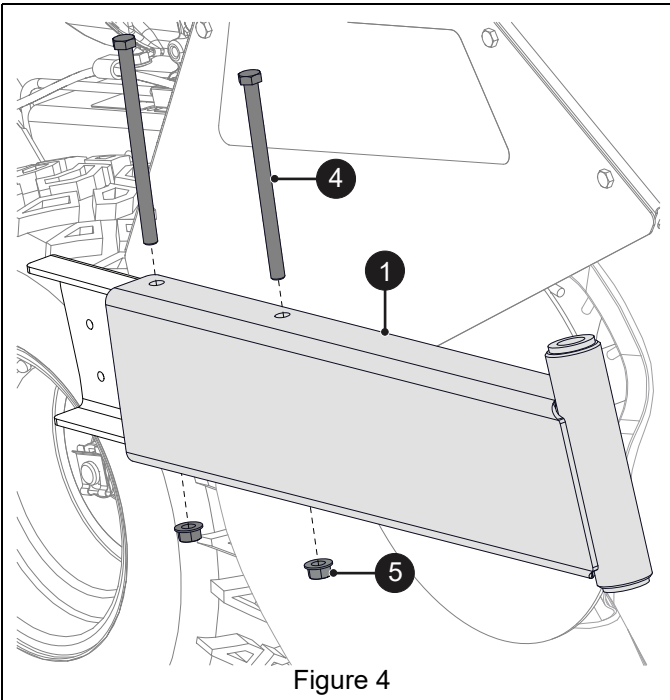

Figure 2

4. Support the right caster wheel assembly. Remove and retain the lynch pin from the top of the caster shaft. Remove and retain caster assembly and height adjuster clips. See Figure 3.



5. Position right caster arm (item 1) on right brush housing bracket and secure with two 3/8" x 5 1/2" hex bolts (item 4) and two 3/8" locking top flange nuts (item 5). See Figure 4.



6. Reinstall caster assembly and secure with lynch pin. Note number of height adjuster clips above and below caster arm. See Figure 5.

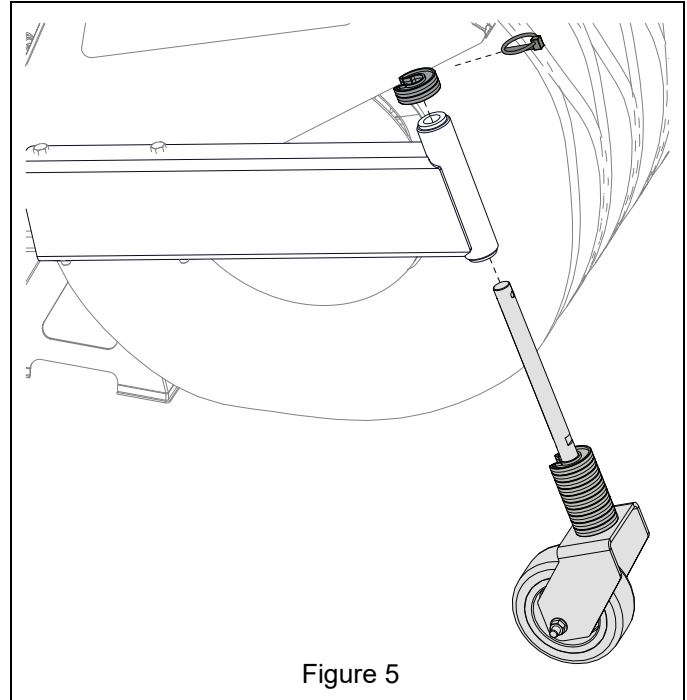

7. Repeat steps 4 – 6 to install left caster arm (item 2) and caster assembly on left side of brush housing.
8. Ensure that left and right casters are adjusted to the same height.
9. Return unit to operating position.

DETHATCHING TIPS

- De-thatch in spring to clear winter undergrowth.
- Adjust brush height so it just touches the grass.
- Set brush angle full left or full right so thatch is cleared only once.
- Use a slow speed to clear thatch to help avoid damage to lawn.