

# Instruction Sheet

## Kit Number: 72406900 & 73203100

### DRIFT CUTTER KIT



**WARNING: FAILURE TO FOLLOW INSTRUCTIONS** could result in personal injury and/or damage to unit.

Read, understand, and follow all safety practices in Owner/Operator Manual before beginning.

### Package Contents

Check the contents of your kit for the parts listed below  
Also see Figure 1.

Item	Description	Qty	AriensCo P/N
1	Drift Cutter (72406900)	2	00262159
2	Cutter Bar (73203100)	2	01024259
3	5/16"- 18 x 3/4" Round Head Square Neck Bolt	4	06200309
4	Clamping Knob	4	07534800

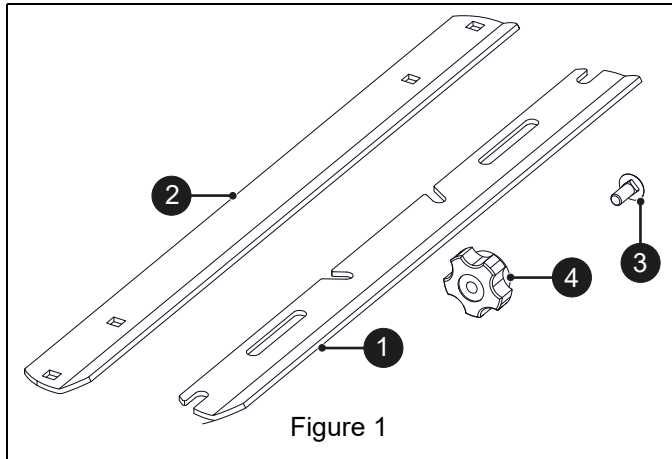

Figure 1

### INSTALLATION AND OPERATION – KIT 72406900

1. Park unit on level surface, stop engine and remove key.
2. Wait for moving parts to stop and for hot parts to cool. See Figure 3
3. Insert one 5/16" x 3/4" round head square neck bolt (item 3) from inside of auger housing through lower middle hole in side housing.
4. Position drift cutter (item 1) with flared edge facing the rear of the unit.
5. Install the drift cutter on the unit through the upper slot on the cutter.

6. Install one clamping knob (item 4) to hold cutter in position. Do not fully tighten.
7. From inside of auger housing, install second 5/16" x 3/4" round head square neck bolt through upper hole in auger housing.
8. Install second clamping knob. Do not fully tighten.
9. Slide drift cutter up so that notch in end rests against upper bolt.

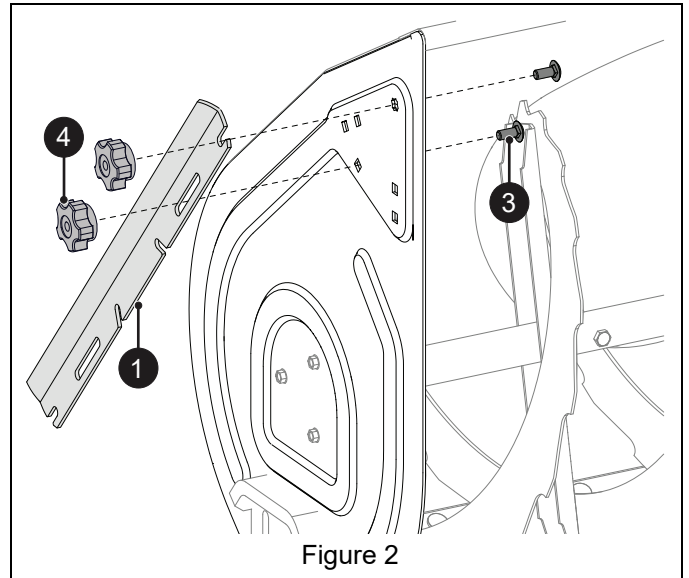

Figure 2

10. Securely tighten hardware. Drift cutter is in storage position.

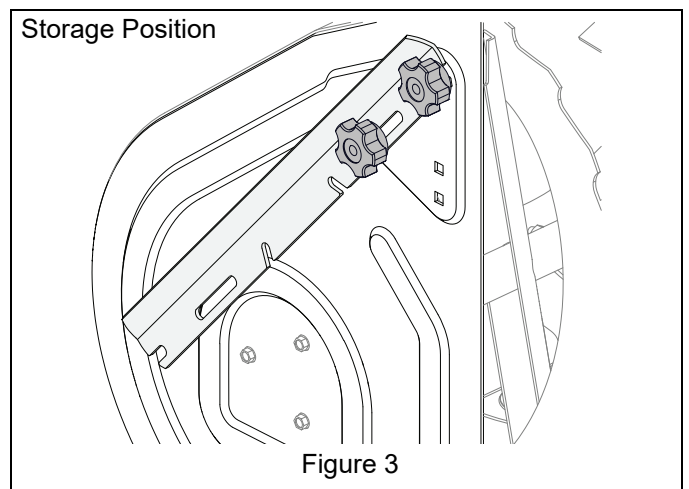
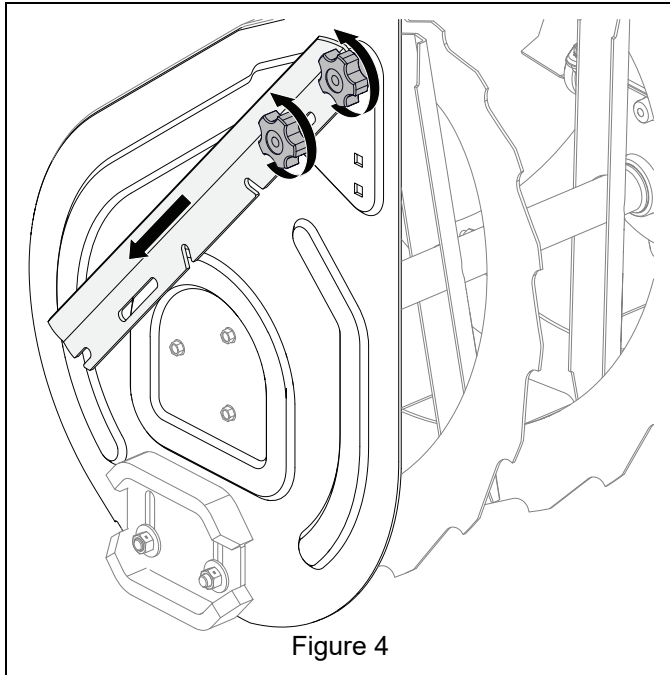

Figure 3

11. Repeat on other side of unit.

## Drift-Cutting Position

1. To move drift cutters to drift-cutting position, loosen but do not remove clamping knobs.
2. Slide drift cutter down and to the rear of the unit. See Figure 4.



3. Rotate drift cutter down and to the front of the unit until the notch in the side of the drift cutter securely seats on the upper bolt. See Figure 5.
4. Securely tighten clamping knobs.

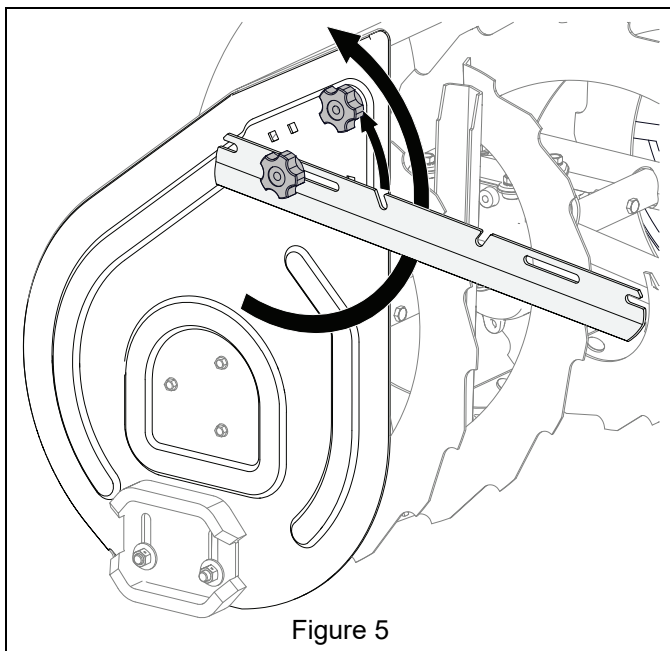

5. Repeat on other side of unit.

## INSTALLATION – KIT 73203100

1. Park unit on level surface, stop engine and remove key.
2. Wait for moving parts to stop and for hot parts to cool. See Figure 6
3. Insert one 5/16" x 3/4" round head square neck bolt (item 3) from inside of auger housing through upper hole in side housing.
4. Position cutter bar (item 2) with flared edge facing the front of the unit.
5. Install cutter bar on unit through the upper hole on the bottom of the cutter.
6. Install clamping knob (item 4). Do not fully tighten.
7. From inside of auger housing, install second 5/16" x 3/4" round head square neck bolt through lower hole in housing and cutter bar.
8. Install second clamping knob and securely tighten both knobs.

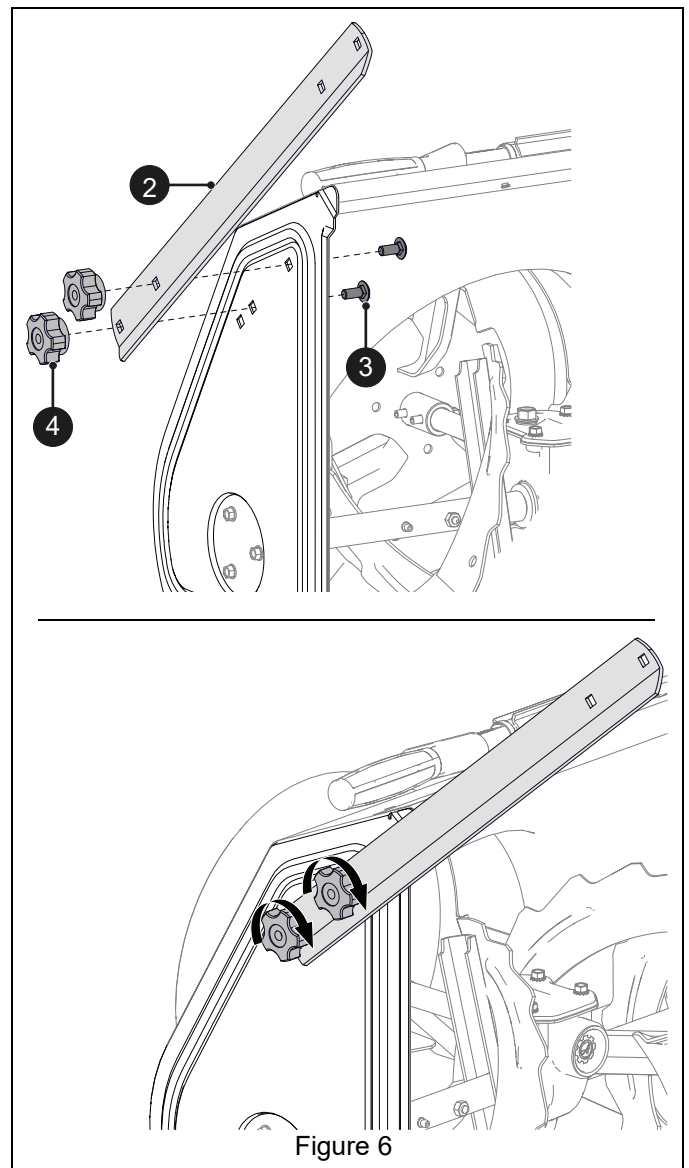

9. Repeat on other side of unit.