

Instruction Sheet

Kit Number: 72602300

36" BRUSH DEFLECTOR KIT



WARNING: FAILURE TO FOLLOW INSTRUCTIONS could result in personal injury and/or damage to unit. Read, understand, and follow all safety practices in Owner/Operator Manual before beginning.

Package Contents

Check the contents of your kit for the parts listed below. Also see Figure 1.

Item	Description	Qty	Ariens P/N
1	36" PB Deflector	1	04658351
2	5/16-18 x 3/4" Round Head Square Neck Bolt	3	06220800
3	5/16-18" PL Wing Nut	3	06503800
4	11/32 x 11/16 x 1/16" Flat Steel Washer	3	06437200

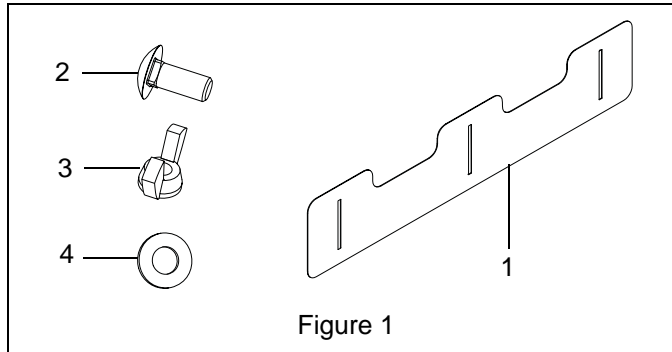

Figure 1

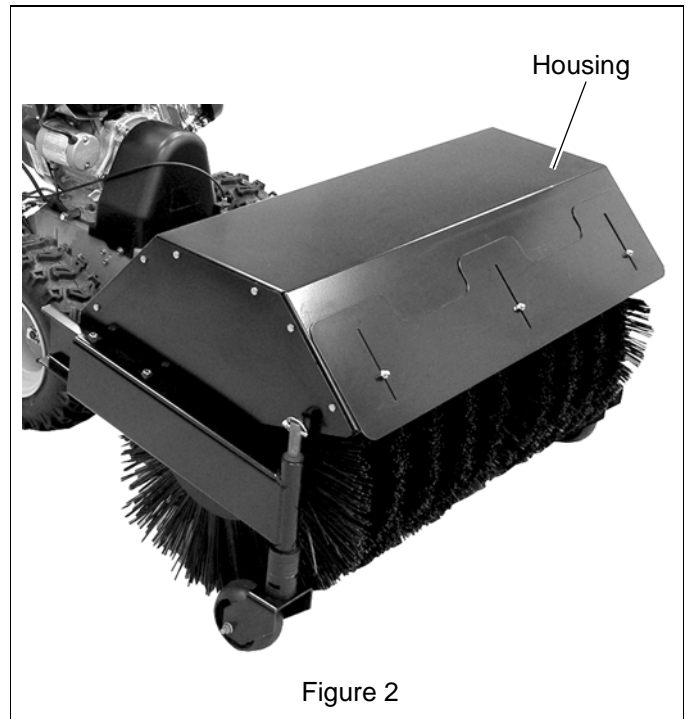

Figure 2

Installation

See Figure 2.

1. Align slots in deflector (Item 1) with holes in housing.
2. Insert bolt (Item 2) through housing and deflector from behind.
3. Insert washer (Item 4) on bolt and tighten with wing nut (Item 3).